

# Installation Manual

For outdoor installation  
Foot-wash bollard light

Model: LLP-7027LUE / LLP-7028LUE

- For outdoor installation (rainproof, moisture-proof, heavy-duty salt-resistant)
- For installation on the ground (Fixed/recessed dual-use)
- With overheat protection function
- LED unit is non-replaceable
- Non-Dimmable
- Cannot be used alone. Dual-use with compatible recessed mounting base or compatible base plate.

## Name of parts

\*The diagram below is a simplified illustration.

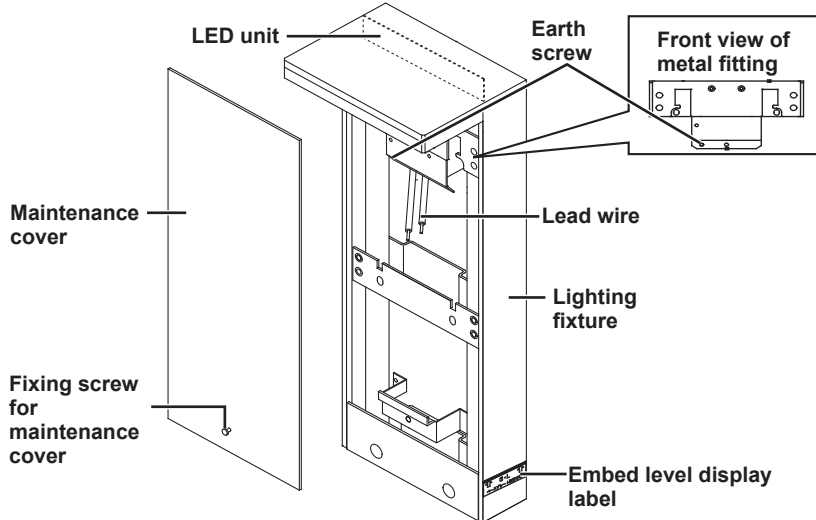

### Enclosed parts

- Mounting screws (x4)
- Hexagonal wrench (L) (nominal size: 3.0)
- Protective tubes (x2)
- Hexagonal wrench (S) (nominal size: 1.5)

### Compatible recessed mounting base (sold separately)

Model No. LLA-7033U

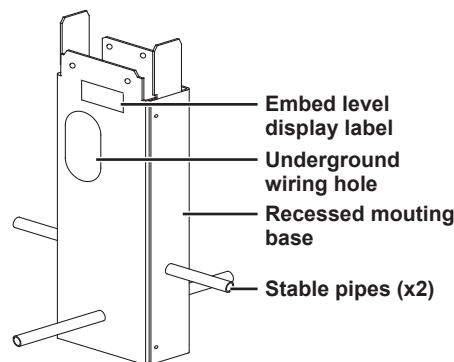

### Enclosed parts

- Stable pipes (x2)

### Mounting dimensions

Unit: mm

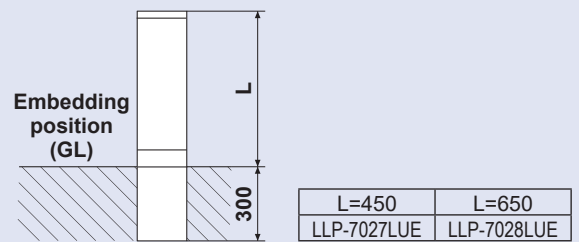

### Compatible base plate (sold separately)

Model No. LLA-7034U

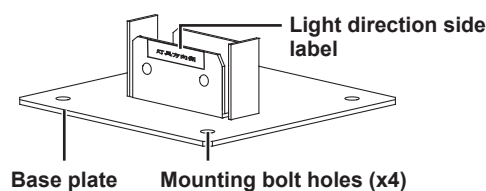

### Mounting dimensions

Unit: mm

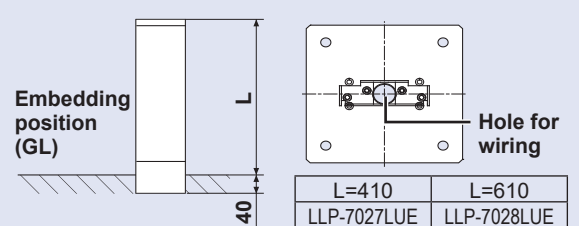

### Precautions before Installation

- During installation, make sure to follow the electrical equipment technical standards and the internal wiring regulations.
  - Use a conduit or similar method to protect the cable up to the underground wiring hole.
- \*The cable, cable and protective conduit are not included with the fixture. Please prepare these separately.
- Make sure to provide drainage.
  - Install the recessed mounting base in a location with solid subsoil and good drainage.

### Warning



**Do not install in the following locations. Doing so may cause insulation failure or tipping.**

- Locations where water accumulates
- Locations with high moisture
- Locations with high humidity
- Locations with soft subsoil

- The embed level display label of the lighting fixture is not needed; please remove it.

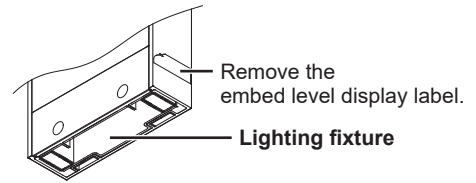

## 1 Embed the recessed mounting base.

\*Provide sufficient drainage to prevent water from accumulating inside the recessed mounting base.

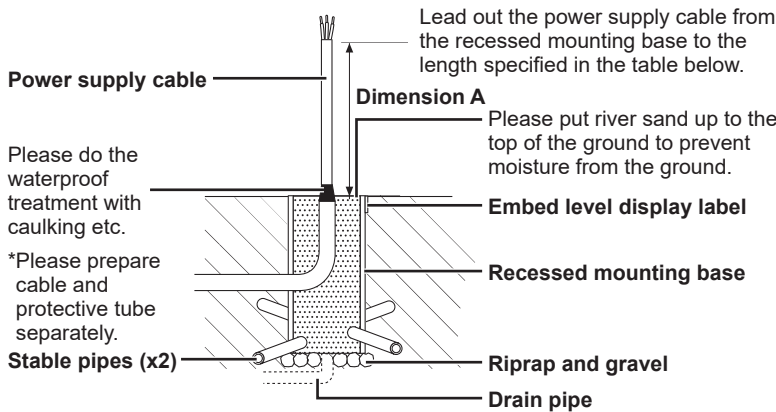

Dimension A	
LLP-7027LUE	LLP-7028LUE
500 mm	700 mm

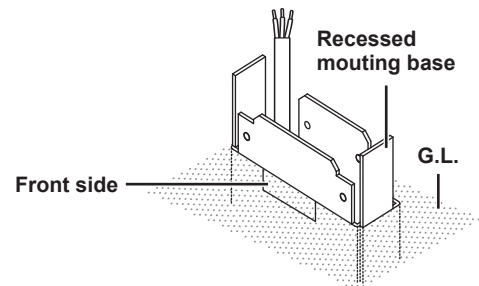

### Warning

**If embedding is incomplete, it may cause insulation failure or tipping.**

## 2 Remove the maintenance cover.

- Loosen the maintenance cover mounting screws with the included hexagonal wrench (S), and remove the maintenance cover.
- (1) Loosen the maintenance cover mounting screws.
  - (2) Lift the maintenance cover upward.
  - (3) Lift the maintenance cover in the direction of the arrow.
  - (4) Pull out the maintenance cover diagonally downward.

### Warning

- Use a compatible electric wire and connect it securely. Insufficient connection may cause fire.
- Do not use at voltages other than the rated voltage. Otherwise, it may cause fire or electric shock.

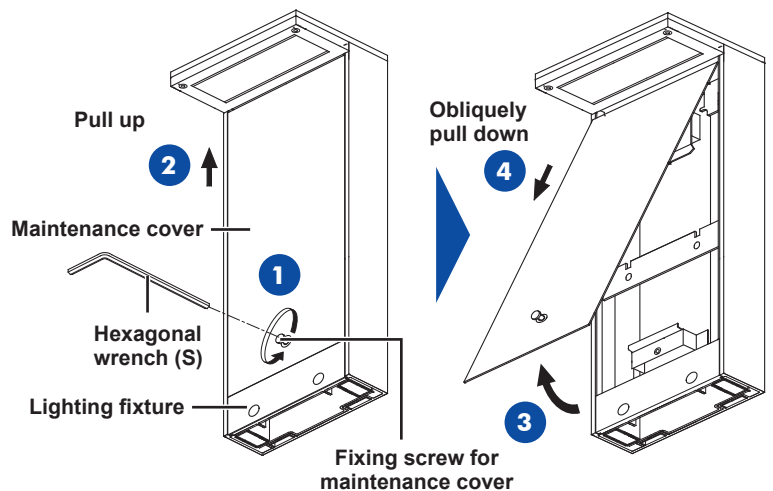

### 3 Install the lighting fixture.

- Set the lighting fixture on the recessed mounting base, then securely tighten and fasten the mounting screws (x4) with the included hexagonal wrench (L).

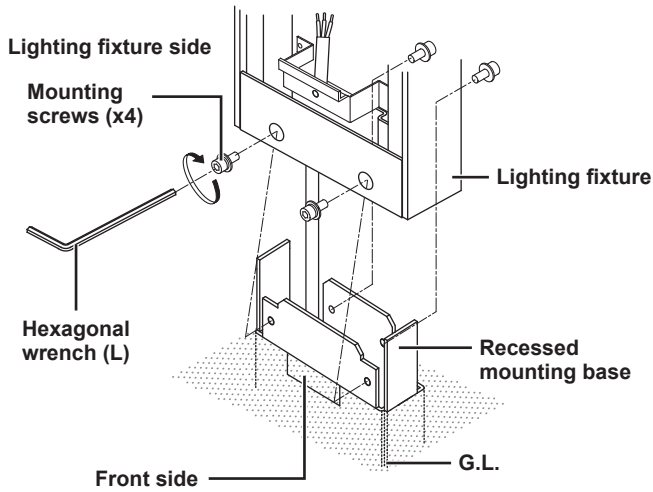

### 4 Connect the power supply cable. (Be sure to turn off the power before starting work.)

- Pass the power supply cable through the cord stopper and protect it with the included protective tubes (L = 100 mm). Next, securely connect the power supply cable and lead wire, and be sure to perform insulation and waterproofing.

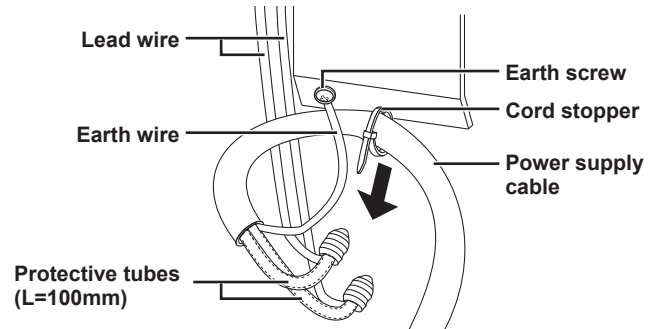

#### Warning

- After wiring, be sure to insulate and waterproof the wires properly. Incomplete wiring can cause fire, electric shock, poor insulation, and electrical leakage.

### 5 Attach the maintenance cover.

- Set the maintenance cover, then tighten the maintenance cover mounting screws with the included hexagonal wrench (S).
- (1) Insert the maintenance cover diagonally from below the lighting fixture.
  - (2) Push in the maintenance cover in the direction of the arrow.
  - (3) Lower the maintenance cover.
  - (4) Tighten the maintenance cover mounting screws.

#### Warning

- Use a compatible electric wire and connect it securely. Insufficient connection may cause fire.
- Do not use at voltages other than the rated voltage. Otherwise, it may cause fire or electric shock.

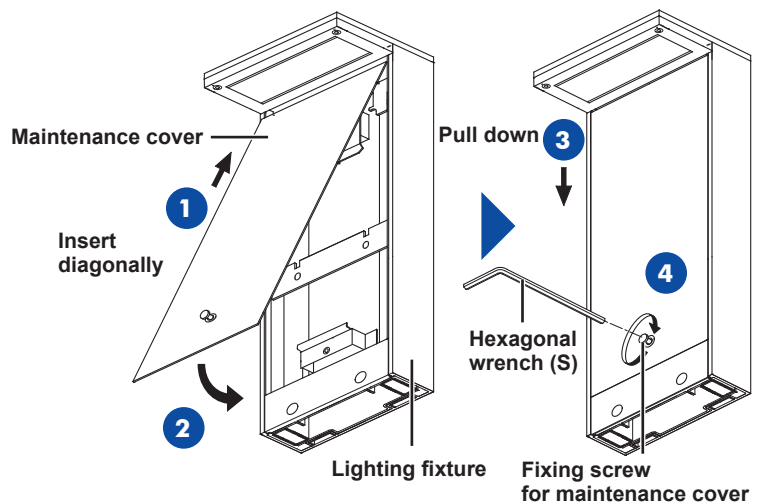

### Precautions before Installation

- During installation, make sure to follow the electrical equipment technical standards and the internal wiring regulations.
- Use a conduit or similar method to protect the cable up to the hole for wiring.

\*The cable, cable and protective conduit are not included with the fixture. Please prepare these separately.

- Please thoroughly drain treatment in the pole.
- Install the base plate in a location with a solid substrate and good drainage.

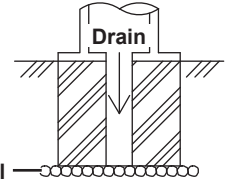

### Warning



**Do not install in the following locations. Doing so may cause insulation failure or tipping.**

- Locations where water accumulates
- Locations with high moisture
- Locations with high humidity
- Locations with soft subsoil

- Make sure the mounting surface of the base plate has a level and smooth finish. Otherwise, it may cause the fixture to tilt as shown in the figure on the right.

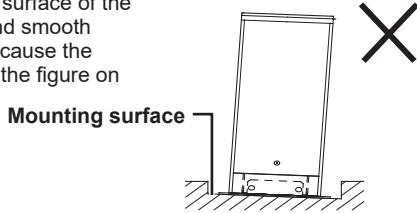

- When installing multiple fixtures, level the fixtures by using the edges of the base plate as a reference.

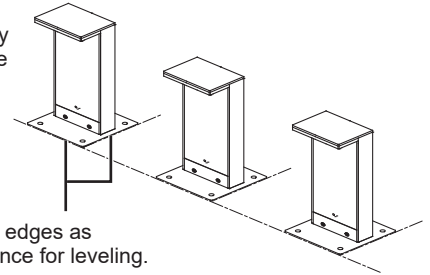

### Caution

- If the mounting surface is not level and smooth, it may cause tilting.
- If leveling is incomplete, it may result in an uneven installation orientation.

## 1 Check the mounting surface.

\*Bolts are not included with the base plate. Please prepare M10 mounting bolts separately.

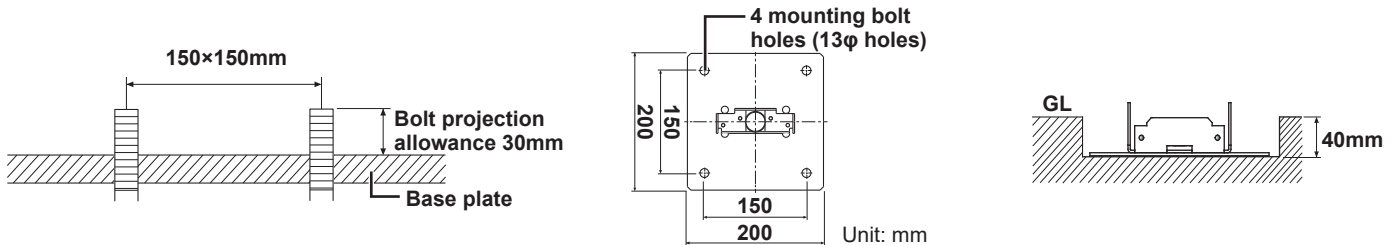

## 2 Install base plate with mounting bolts.

\*Washers, spring washers and nuts are not included with the fixture. Please prepare M10 washers, spring washers and nuts separately to match the bolts.

\*Provide sufficient drainage to prevent water accumulation

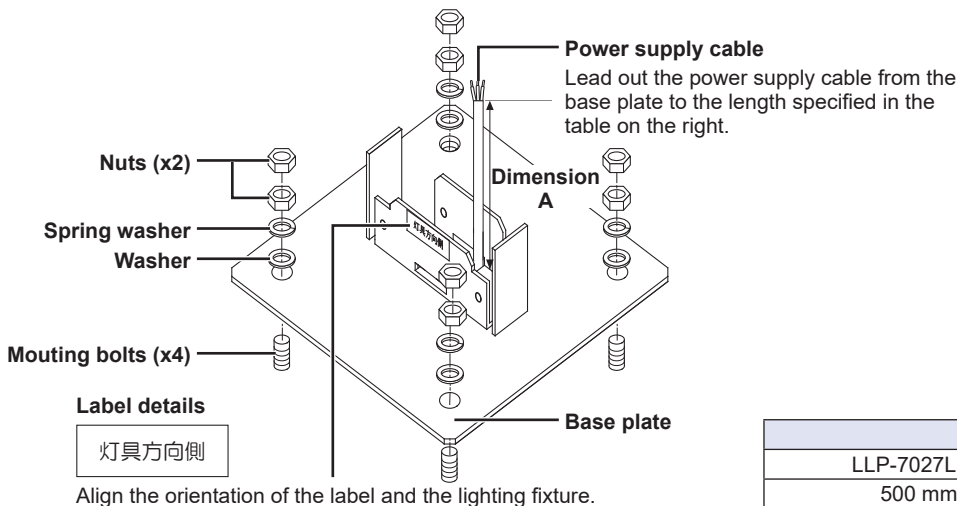

Dimension A	
LLP-7027LUE	LLP-7028LUE
500 mm	700 mm

### 3 Remove the maintenance cover.

See P.02, Step 2.

### 4 Install the lighting fixture.

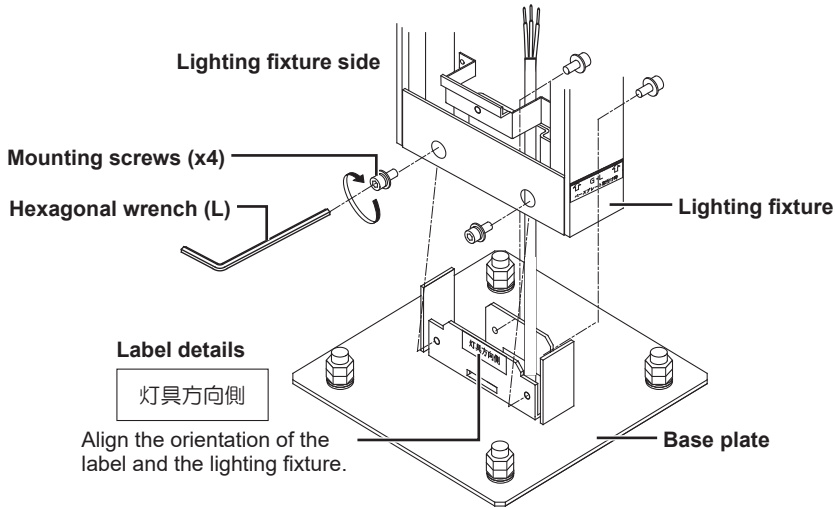

### 5 Connect the power supply cable. (Be sure to turn off the power before starting work.)

See P.03, Step 4.

### 6 Attach the maintenance cover.

See P.03, Step 5.

### 7 Embed the lighting fixture in the ground.

