

Installation Manual

Ceiling-recessed adjustable downlight

Model: LLD-7061LUN / LLD-7061YUN / LLD-7061AUN
 LLD-7061LUM / LLD-7061YUM / LLD-7061AUM
 LLD-7061LUW / LLD-7061YUW / LLD-7061AUW
 LLD-7061LUB / LLD-7061YUB / LLD-7061AUB

- For eaves installation (rainproof, moisture-proof, heavy-duty salt-resistant)
- For ceiling installation (recessed type)
- Spring mounting method
- LED unit is non-replaceable

Name of parts

*The diagram below is a simplified illustration.

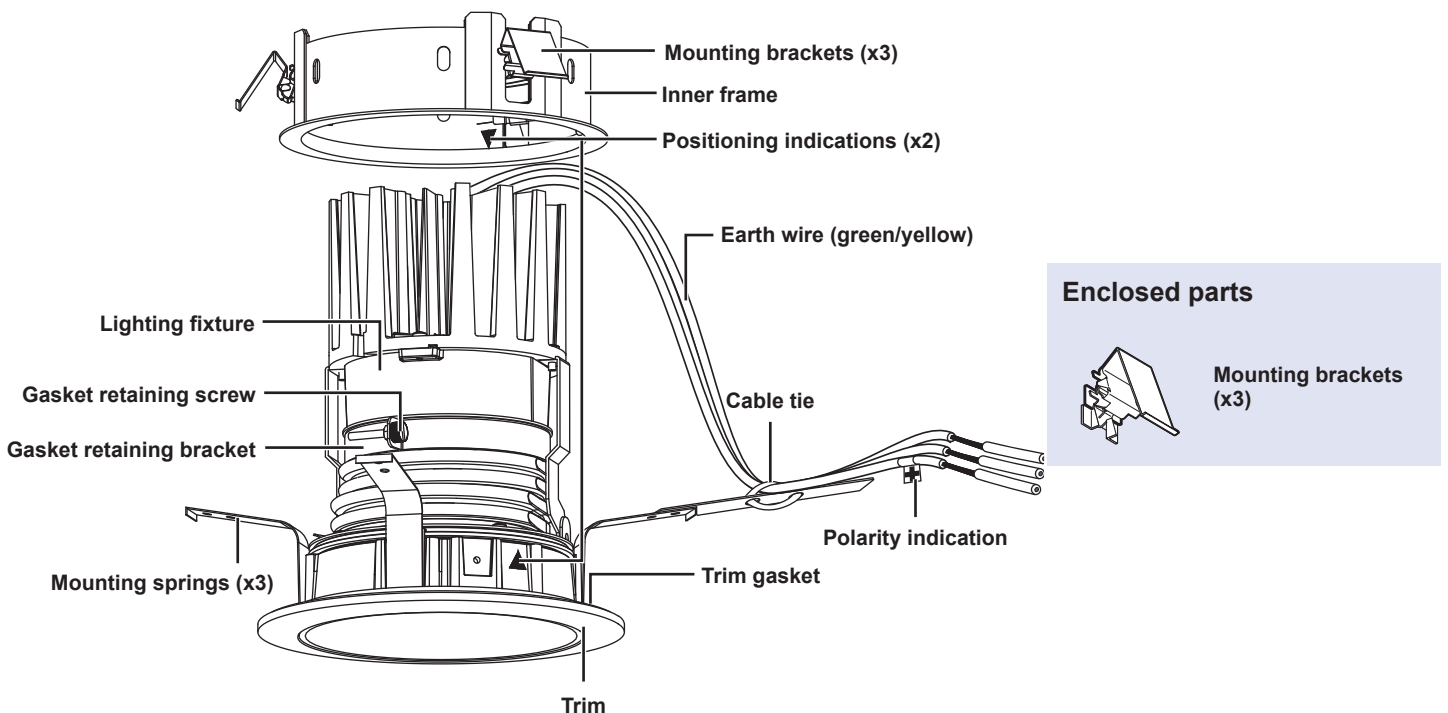

Precautions before Installation

- When installing on the following types of ceilings, be sure to insert reinforcement material (such as steel plates or wooden blocks) between the mounting brackets of the inner frame and the ceiling.
 - Soft ceilings such as mineral wool
 - Ceilings made of calcium silicate boards
- Install the fixture only after the mounting surface is fully dry. If not fully dried, the plating or painted parts of the fixture may be damaged, or it may cause insulation failure.
- For ceilings with surface irregularities of 1 mm or more, counterbore and flatten the surface. If installed as is, it may cause light leakage or reduced airtightness.

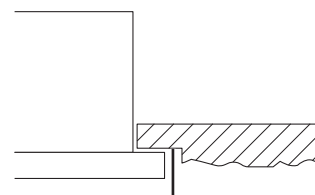

Installation Procedure

1 Check the ceiling surface.

- Check the cutout hole, required recessed height, applicable ceiling thickness, and required movement range.

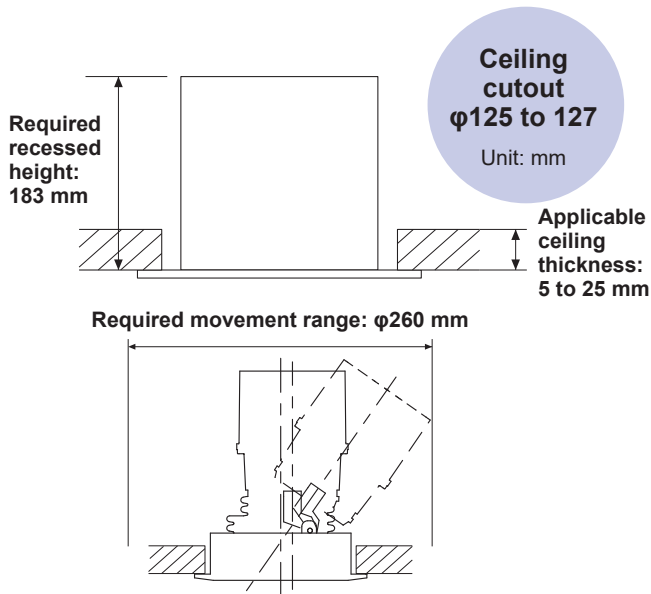

2 Install the inner frame.

- Insert the inner frame into the ceiling cutout and push it up.

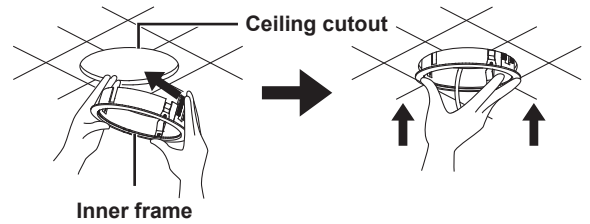

- ① Insert the tabs of the mounting brackets into the bracket mounting section.
- ② Press the mounting brackets down with your fingers and secure them firmly.

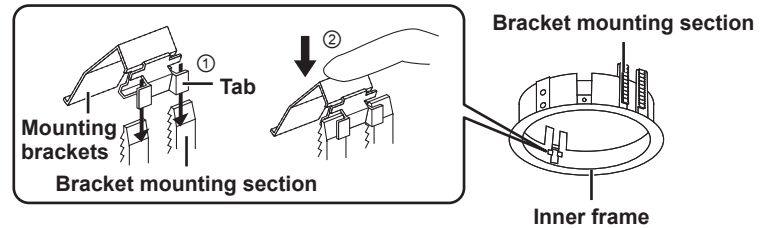

- To remove the inner frame, push up the mounting brackets and remove the inner frame from the ceiling cutout.

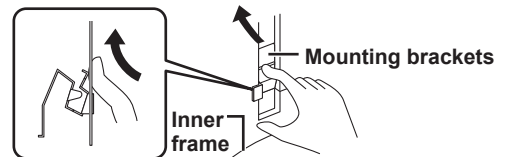

3 Connect the lighting fixture cable to a remote LED power supply. (Be sure to turn off the power before starting work.)

- *Use an earth wire and be sure to perform grounding work.
- *Pay attention to polarity.

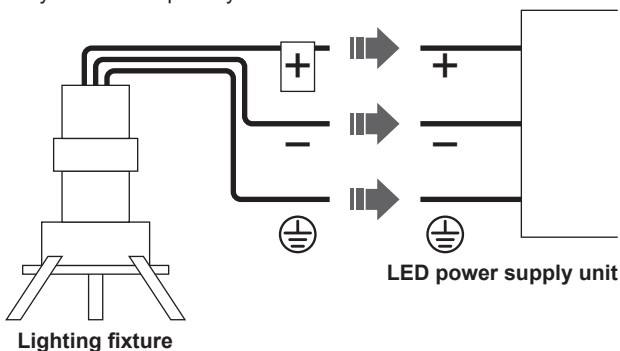

4 Insert the LED power supply unit.

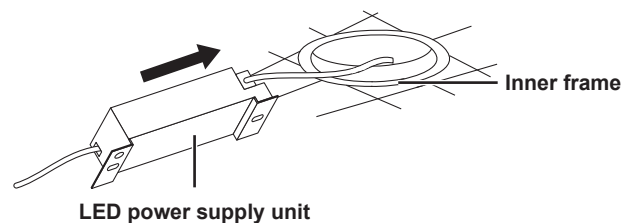

5 Install the lighting fixture.

- Align the positioning indications on the lighting fixture and the inner frame.
- Push down the mounting springs (x3) as you push the lighting fixture into the inner frame.

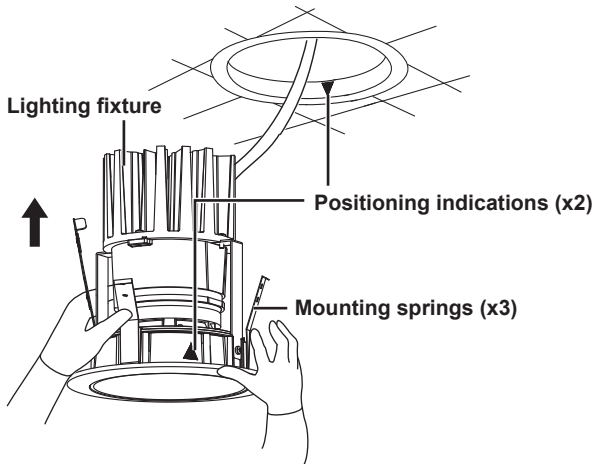

6 Adjust the light aiming angle.

- Range of movement

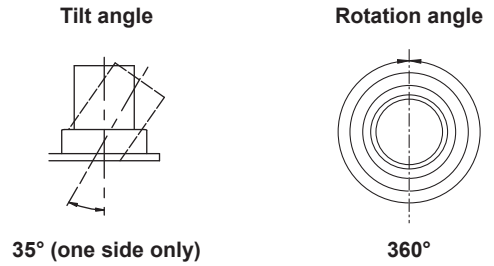

7 Installation of optional accessories

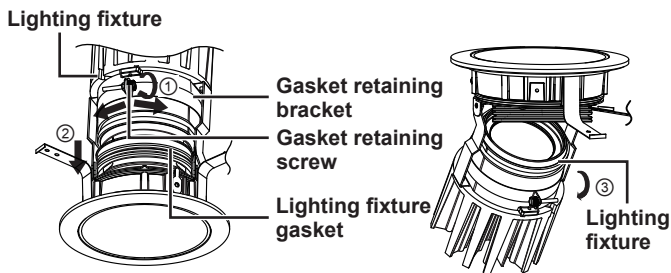

<Installation method>

- ①② Loosen the gasket retaining screw, slide the gasket retaining bracket toward the lighting fixture, then remove the lighting fixture gasket.
- ③ Tilt the lighting fixture and install the option (sold separately) as shown in the figure on the right.
- ④ Install the lighting fixture gasket using the gasket retaining bracket in the reverse order of steps ① and ②.

Warning

Failure to install the gasket retaining bracket correctly can cause water or moisture to enter the ceiling.

- When installing an option, install it as shown in the figure below.

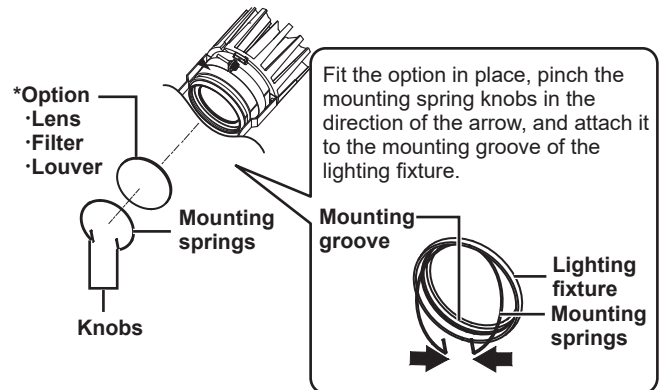

Warning

Insufficient installation can cause it to fall.